



GUEST MANUAL

Phone Numbers

Property Address.....	471 S. Calle El Segundo #C-19 Palm Springs, CA 92262
Emergency.....	911
Police & Fire Emergency	911
Police - Non Emergency	760-323-8116
Poison Control Center	800-222- 1222
Owner Jim Hahn	269-262-5040
Trash - [Palm Springs] Disposal Service	760-327-7283
Dental Referral Service	800-336-8478
Desert Regional Medical Center	800-491-4990
Tourism - City Agency	760-778-8418 www.visitpalmsprings.com
Palm Springs Visitor Center.....	760-778-8418

Health, Fire and Safety

Fire Extinguisher is located on the wall to the right of the refrigerator.

Smoke Alarms are located on ceiling by door-way from dining room to the bedroom. There is a wired-in 120V detector with battery back-up in the event of a power failure. There are also battery operated smoke alarms. The 9V batteries are replaced seasonally, but if for some reason it becomes weak, the unit will emit a low beeping sound to alert you to change the battery.

A **First Aid Kit** is located in the Bathroom cabinet under the sink.

For **Fire , Police, Ambulance, etc . call 911.**

The **Electrical Panel** is located behind the door separating the Bedroom from the Dining Room . You should only have to access this in the event that a circuit breaker trips and requires re-setting.

Barbecue

There is a barbecue grill located on the back balcony for your use. You can find the grilling utensils in the kitchen. To light the grill, turn on the gas valve located on the tank and then follow the instructions printed on the front of the grill. Please turn off the tank's gas valve off when you finish using the grill. Please note that the valve on the tank must be open to read the fuel gauge.

Television

All the audio/video equipment is located beneath the living room television. Your TV watching is done through Apple TV. To power up or down the Apple TV, all you need to do is press the power button on the upper right corner of the AppleTV remote. Powering down will require you to hold the power button for a couple seconds. Once this is done, all devices, television, soundbar, and Apple TV will all respond together. To watch broadcast and cable television, you simply need open the YouTubeTV app with the Apple TV remote. If YouTube TV asks you which user is watching, choose "JDKLHideAway". If you have other subscriptions like Netflix, HBO, Paramount, etc., and wish to use them, you may choose those apps and sign in with your username and password. Don't forget to sign out before you check out.

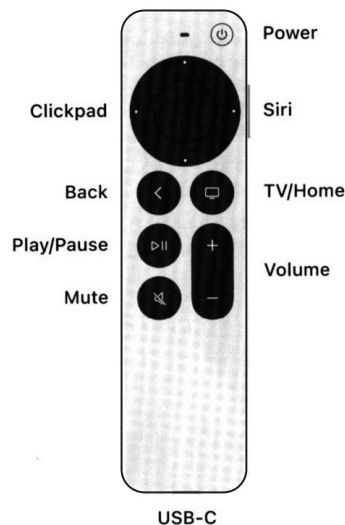

- Clickpad**
Press up/down/left/right or swipe touch surface to navigate. Press center to select.
- Back**
Press to return to previous menu. Press and hold for Home Screen.
- Siri**
Press and hold to talk.
- TV/Home**
Press for Apple TV app. Press and hold for Control Center.
- Charging**
Connect a USB-C cable (not included).

Internet

The wifi network name is "Puttin on the Biar-Ritz" and it requires the password **5G4233200312.**

Laundry

Laundry rooms are located on the parking level at the south end of the C building (near Ramon Road) and both ends of D building. The machines take American quarters. You can also download the app to your device to pay for the washer and dryer machines (app instructions are located in the laundry rooms. You will need to use your "common area" key... the one for the gates and pool. If you choose to launder any bedding or towels, etc. Please use fragrance free detergents and fragrance free fabric softeners (including dryer sheets).

Do not wash the white sheets and towels with any colored towels, sheets, or clothing. If colors bleed on to the white towels or sheets, we will have to replace them at your expense.

Linens

Pool towels, and additional bathroom towels and linens are located in the cupboard to the left of the bedroom patio door.

Air Conditioner Policy

PLEASE READ - your Security Deposit may be at risk! To Insure your comfort, please follow these simple steps.

On your arrival, thermostats are normally set between 78 and 85 with switch on COOL, and fan on AUTO. If the living area is too warm for your enjoyment, make sure the switches are set to COOL and AUTO, then set the thermostat no more than 5 (five) degrees lower than the current temperature in the room.

DO NOT LOWER the temperature on the thermostat more than five-degrees at a time or the air conditioner may freeze up , shut down and blow hot air.

Once the living area has begun to cool down, and the air has cycled off, wait several minutes for the unit to defrost then turn down the temp another 3 to 5 degrees and repeat the process as needed. Always wait several minutes after the air has cycled off before starting again.

Please do not set temperature lower than 76 degrees at any time, especially when It Is very hot outside, as this may cause the unit to freeze. Setting the temperature too low will not cool the room faster but it will cause the air conditioner to freeze-up and shut off.

If the A/C freezes up, the solution is to turn the system to " OFF", and switch the fan from "AUTO" to "ON" and let the fan run for approximately 1 to 2 hours. This will de-ice the air conditioner. Then switch back to COOL and AUTO and start again.

Depending on conditions, It may take several hours for the living area to cool down. If after 3 hours or so, the temperature has not fallen (feel for the airflow directly at the vent) It should feel cooler than the room air. If not, please call me at 269-262-5040. We will send a repairman to you as soon as possible.

If the vents are blowing cool air, the only solution Is patience, Its working and will eventually cool down.

If the air conditioner Is frozen up, not due to mechanical failure you may be charged for the service.

Maintenance and Repairs

For any issues with the condo, building, or property, please call me at 269-262-5040.

Parking and Map of Property

See map below for location of the designated covered parking spot for unit C-19. The parking spot is marked 69P. Please make sure not to back-in to parking stall. You can also see layout of complex.

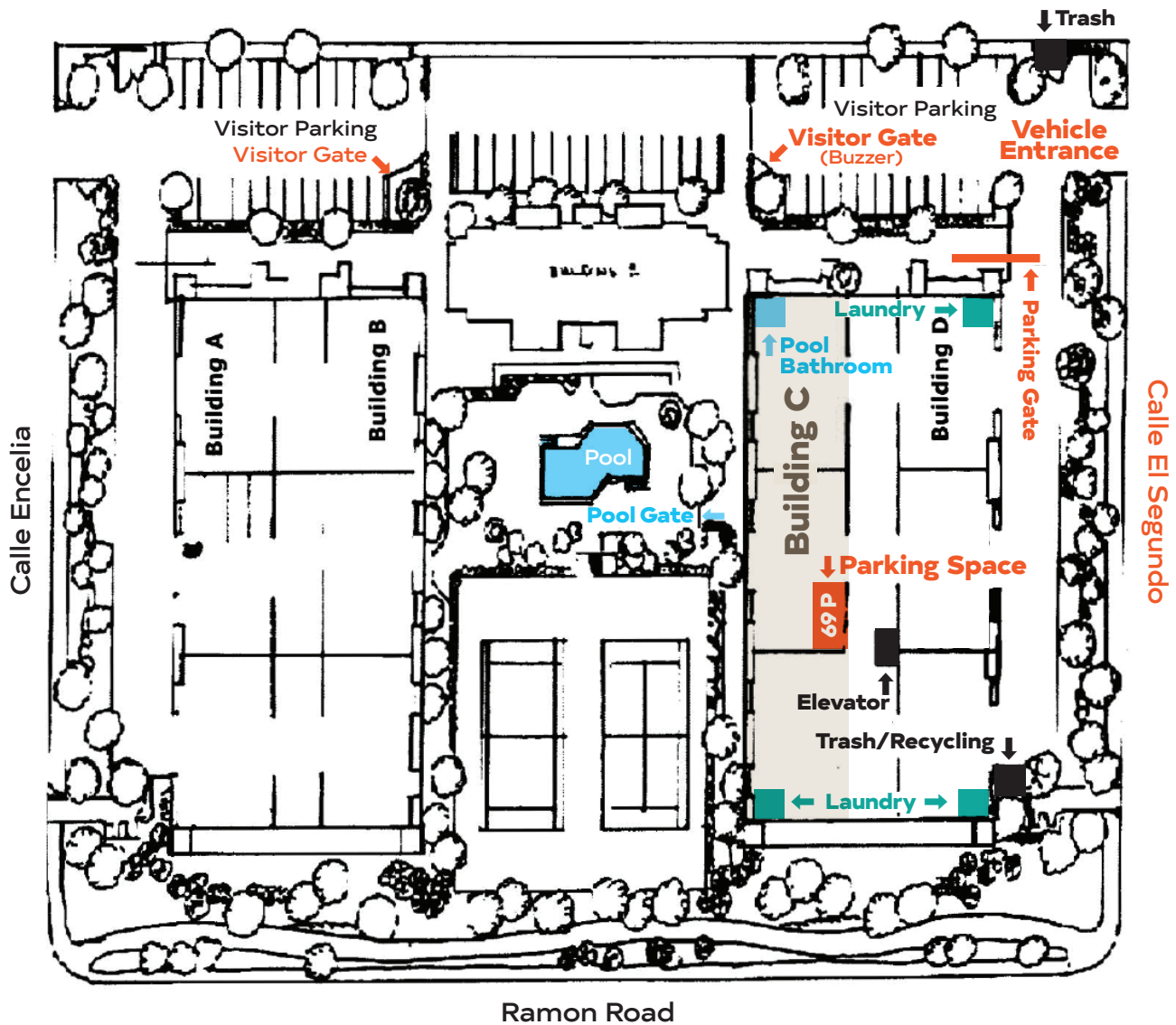

Waste Disposal and Recycling

Garbage and recycling areas are located at the South & North ends of building D.

Items you can Recycle:

Aluminum Cans
Assorted Food Jars and Bottles
Assorted Plastics
Beer Bottles
Brochures
Cardboard
Catalogs
Cereal Boxes
Computer Paper
Condiment Jars
Crayon Drawings
Egg Cartons
Envelopes
Food Boxes
Fruit & Vegetable Cans
Jam & Jelly Jars
Juice Bottles
Juice Boxes
Juice Cans
Junk Mail
Metal Coat Hangers
Magazines
Mixed Paper
Milk Cartons
Newspapers
Pet Food Cans
Plastic Grocery Bags
Plastic Laundry Jugs
Plastic Soda Bottles
Shampoo/Lotion Bottles
Soda/Beer Cartons
Soda Cans
Styrofoam
Telephone Books
Tissue Boxes
Wine & Liquor Bottles
Wrapping Paper

These Items are NOT Recyclable

Animal Waste
Bubble Wrap
Cactus
Concrete
Diapers
Dirt
Food Waste
Garden Hose
Kleenex
Light Bulbs
Lumber
Padded Envelopes
Paper Towels
Plastic Wrap
Rocks
Sharps
Trash
Window Glass
Mirror Glass
Motor Oil

Checking Out

- Checkout is no later than 10am, unless you have arranged for a later departure.
- Load and start the dishwasher.
- Clean up any spills on tables, counters, and floors.
- Make sure the grill is clean and covered.
- Remove all trash and recycling to the Trash/Recycling receptacles (see Biarritz diagram).
- Turn off all lights, TV's, etc.
- Close and lock all doors, windows and shades
- Turn Air-Conditioning up to 90° - off in the winter
- Leave all sets of keys and garage gate opener on the kitchen counter



*We sincerely hope
you enjoy your stay!*